

HI932933 Network Box for HI932 Automatic Potentiometric Titrator

Dear Customer, thank you for choosing Hanna Instruments.

For more information about Hanna Instruments and our products, visit www.hannainst.com or e-mail us at sales@hannainst.com. For technical support, contact your local Hanna Instruments office or e-mail us at tech@hannainst.com.



Scan the QR code or use the link to download the user manual: <https://manuals.hannainst.com/HI932>

Package Contents

Each HI932933 is supplied with quick reference guide and quality certificate.

General Description

The HI932933 is a secure network device designed for the Hanna Instruments® HI932 Automatic Potentiometric Titrator running software version 2.2.0 and higher.

The HI932933 enables a secure network (Ethernet) connection for data exchange and adds USB printer support, allowing direct printing of reports, methods, and data logs.

Specifications

Connection type	Attached USB-C cable
Power source	HI932 Automatic Potentiometric Titrator (USB-COM port)
Ethernet input	RJ-45 Ethernet connector (10/100 Mbps connection)
Status indicator	LED color-coded system
Dimensions	70 × 105 × 50 mm (2.7 × 4.1 × 1.9")
Weight	150 g (0.33 lb)

Key Features

- Support for USB printing
Prints all HI932 Titrator generated files: methods, reports, data logs.
- Network connectivity
Allows the HI932 Automatic Titrator to connect to a laboratory network for data exchange (text/PDF), integrating with Laboratory Information Management Systems (LIMS).
- FTPS & SMB transfer
FTPS and standard (SMB) network file transfer protocols to move data files from the HI932 Automatic Potentiometric Titrator to network storage.
- Secure TLS connection
Encrypts transferred data.
- Trusted Platform Module (TPM) 2.0 device
Provides hardware-based security for key storage, encryption, and platform integrity.
- Upgrade support
Able to install updates to patch vulnerabilities and add features.



Hanna Instruments is committed to developing and deploying digital solutions with a positive impact on the environment and climate.

Please retain for future use.

QR932933 05/26

All Hanna instruments conform to the CE European Directives and our production facilities are ISO 9001 certified. HI932933 is warranted for a period of two years against defects in workmanship and materials when used for its intended purpose and maintained according to instructions.



Connect HI932933 Network Box to the HI932 Titrator

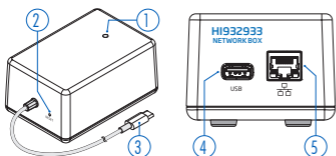

1. LED
2. Reset button
3. Attached USB-C cable
4. USB port for printer
5. Ethernet connection port

- Locate the rear panel of HI932 titrator and plug the USB-C end (3) into the titrator's USB-COM port (6).
- Plug the printer directly into the USB port (4) on the network box.
- Plug the Ethernet cable into the Ethernet connection port (5).

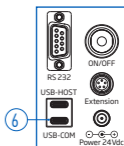

Network Box LED Notifications

When the titrator and the plugged-in network box are connected to power, the HI932 titrator enters system configuration mode. The network box is automatically detected and recognized. The LED on the network box (1) turns on, indicating active network communication.

LED	Behavior	Operational Status	Description
○	Static	Not connected	The network box is booting up.
●	Static	Active	Once the file is loaded or a job sent, the LED turns blue, indicating active processing.
●	Static	Ready	The network box is initialized and waiting for data.
●	Static	Active	Firmware update in progress.
●	Static	Error/Timeout/Blocked	Error

Printing and File Sharing Environment Workflow

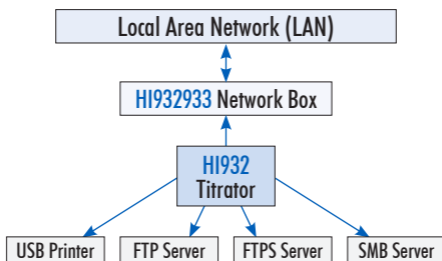

- The HI932 titrator generates the titration report and sends the report to the network box.
- Methods, reports, and summaries are uploaded to the FTP, FTPS, or SMB servers.
- HI932933 box acts as a print server, managing requests from both users and the titrator.
- The print job is sent to the USB printer, via the USB print server function, for local printing.

Troubleshooting

- Ensure all USB or Ethernet cables are securely connected to the titrator and the network box.
- For Ethernet-based connections, the network box and the PC must be on the same network.
- Restart hardware. Power down the titrator, the network box, the PC; and then restart.
- Ensure HI932 titrator firmware is up to date (version 2.2.0 and higher).